

The Dirty Truth Behind Hand-Washed Bedpans

When you ask your carers to wash bedpans by hand, you put everyone in your facility at risk. Handling human waste that is potentially infected with C-diff or coronavirus will make deadly viruses spread, fast.

IT'S TIME TO PROTECT YOUR WORKERS AND RESIDENTS, AS WELL AS YOUR BUDGET AND TIME.

Do you know how long it takes to wash a bedpan?



Washer Disinfector

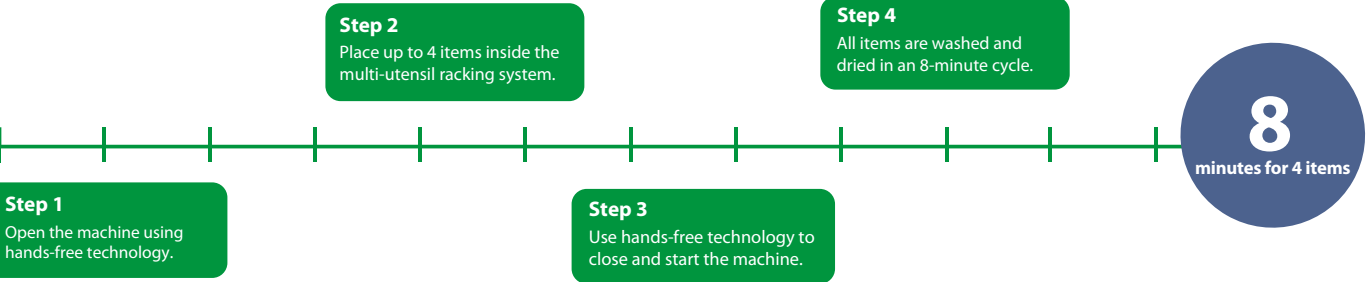

Washing by Hand

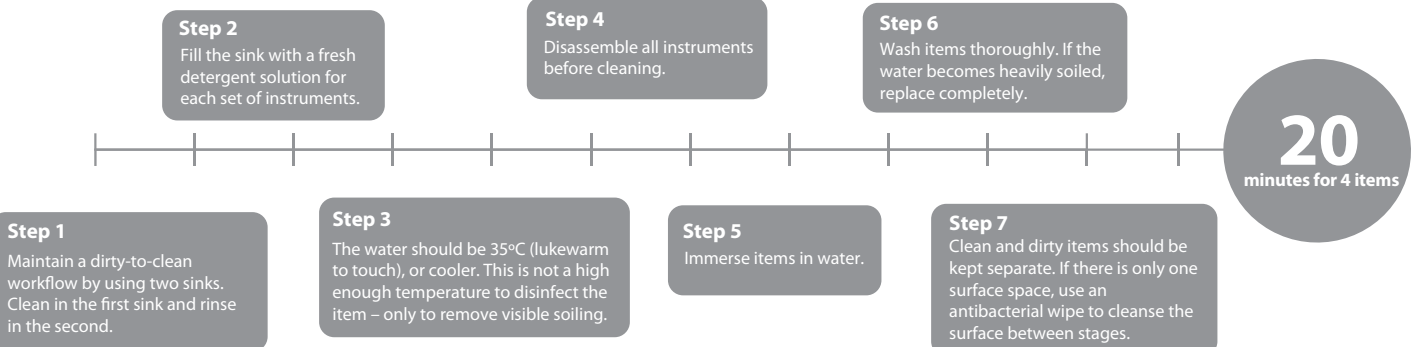

WASHING BEDPANS BY HAND HAS A COST. SWITCH TO THE DDC DOLPHIN PANAMATIC WASHER DISINFECTOR BEFORE YOU PAY THE PRICE.

